

Brislington Park & Ride – Hicks Gate roundabout

Have your say - A4 Bath to Bristol

In this section, the proposals include new bus and cycle lanes.

We're asking for your views and comments at a very early stage before we progress any further. **Nothing is decided at this stage.** The detail still needs to be assessed and is not fixed yet, we'd like your feedback on the overall ideas, rather than the details - what you like, what you don't like, and why. Your feedback will shape what happens next.



Proposals on the A4 at Brislington Park & Ride include improved walking, cycling and bus infrastructure

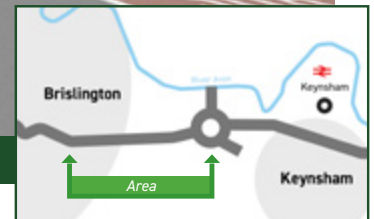

Proposals in detail

- The existing bus lanes would be extended to create new, virtually continuous bus lanes in both directions between the Emery Road junction and Hicks Gate roundabout
- The number of lanes available for other vehicles would be reduced- although drivers will still be able to approach Brislington Park & Ride via the nearest section of bus lane.
- Bus stops along the route would be built to the same standard (subject to space). This could include new shelters where there aren't any, step-free kerbs and live digital bus information screens.
- A segregated two-way cycle path would be created on the left-hand side of the road heading towards Bristol. This would continue along the Keynsham bypass offering a safer route to Keynsham town centre via the new mobility hub, and also connect with:
 - The new cycle path proposed along Emery Road towards Victory Park and St Brendan's Sixth Form College
 - National Cycle Network route 16 via a new dedicated cycle crossing just to the north of Hicks Gate roundabout
- Clearly marked cycle-friendly crossings would be built which could include signals which activate green lights when they detect cyclists. Better crossings would be designed to make it easier and safer for pedestrians
- The narrow footpaths would be widened along the left-hand of the road heading towards Bristol and plant new trees and shrubs.
- To make room for the new bus lanes and cycle path, we would need to extend into some land next to the road with the loss of some existing trees and bushes. We are planning to replace any trees lost and will make a commitment to make sure the natural habitat for wildlife is in a better state than it was beforehand.
- Better connections at Hicks Gate roundabout - Future opportunities for improving connections at Hicks Gate roundabout are also being explored. This could include creating a "mobility hub" connecting with WESTlink buses or moving the Park & Ride. This is not part of this project but could be delivered in the future.

Section of A4 Brislington Park & Ride

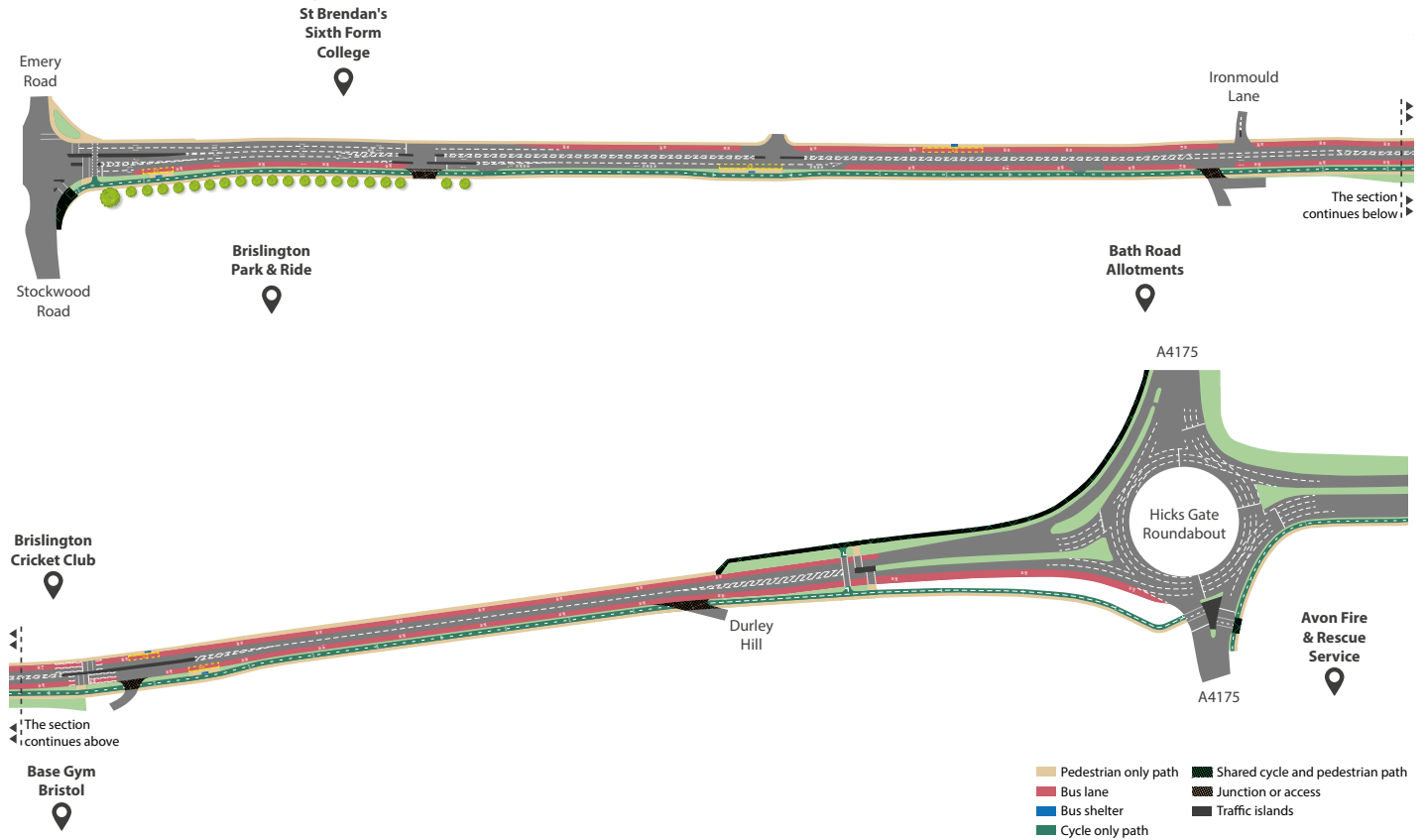

Proposals on the A4 between Brislington Park & Ride and Hicks Gate Roundabout

What could this mean?

- Quicker bus journeys during busy travel times, and buses would generally be more reliable
- Safer cycling route and better connections to the national cycling network
- Safer and more pleasant for walking

But

- Could be slower for cars, vans and lorries
- Some loss of trees and shrubs

Have your say

For further information and to fill in the online questionnaire, please visit the website haveyoursaywest.co.uk or scan the QR code.

